

**All INDIA INSTITUTE OF MEDICAL SCINECS (AIIMS),  
NEW DELHI**

**Tender**

**For**

**Supply, installation, testing & commissioning of Dining Furniture including other related miscellaneous works etc. for Dining Block at All India Institute of Medical Sciences (AIIMS) at Ansari Nagar, New Delhi.**

**Volume-V**

**Tender Drawing**

**MAY 2014**



**HSCC (INDIA) LTD.**

**(CONSULTANTS & ENGINEERS FOR MEGA HOSPITALS & LABORATORIES)**

**E-6(A), sector-1, NOIDA(U.P) 201301 (India)**

**Phone : 0120-2542436-40**

**Fax : 0120-2542447**

**PQ tender No. HSCC/AIIMS-Dining/Fur/2014**

This drawing with all its contents is the sole intellectual property of the Hospital Services Consultancy Corporation (India) Ltd. Copying of this drawing or part thereof, or its use in any form whatsoever without the written permission of HSCC is prohibited.

NORTH

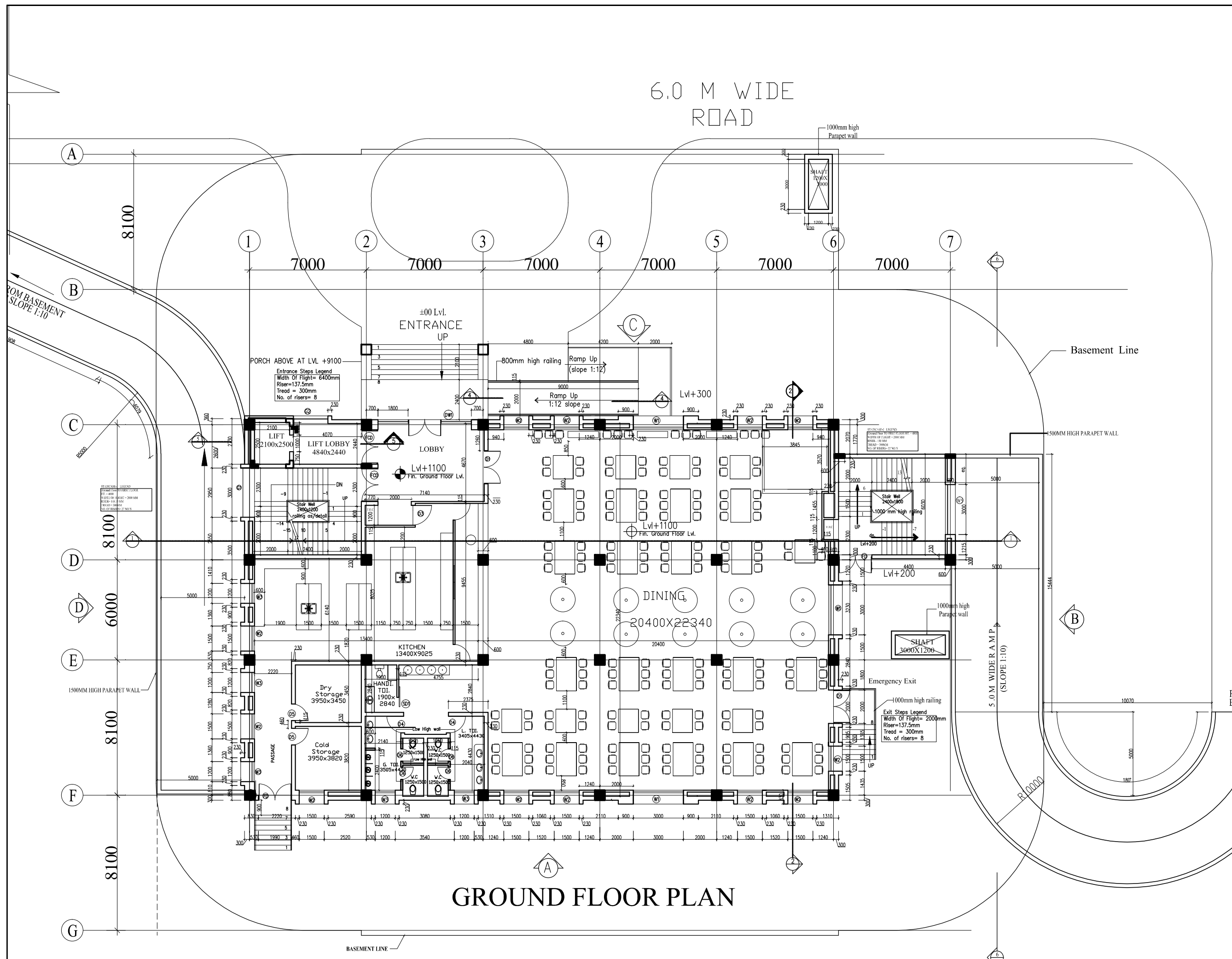

GROUND FLOOR PLAN

**PROJECT**  
**Proposed Master Plan  
 Redevelopment For  
 Masjid Mod**  
 All India Institute of  
 Medical Science  
 New- Delhi

**TITLE**  
**WORKING DRAWING**  
 BLOCK P-16  
 (DINING&PARKING BLOCK)

GROUND FLOOR PLAN

HSCC/ /002/WD/DB/003/R  
 Drawing No.

HSCC/ Job No.	1:100 Scale	JUN 2012 Date
------------------	----------------	------------------

App by	Rev. by	Prep. by
--------	---------	----------

HSCC (INDIA) LIMITED  
 (A GOVERNMENT OF INDIA ENTERPRISES)  
**HSCC**  
 NEW DELHI INDIA

This drawing with all its contents is the sole intellectual property of the Hospital Services Consultancy Corporation (India) Ltd. Copying of this drawing or part thereof, or its use in any form whatsoever without the written permission of HSCC is prohibited.

NORTH

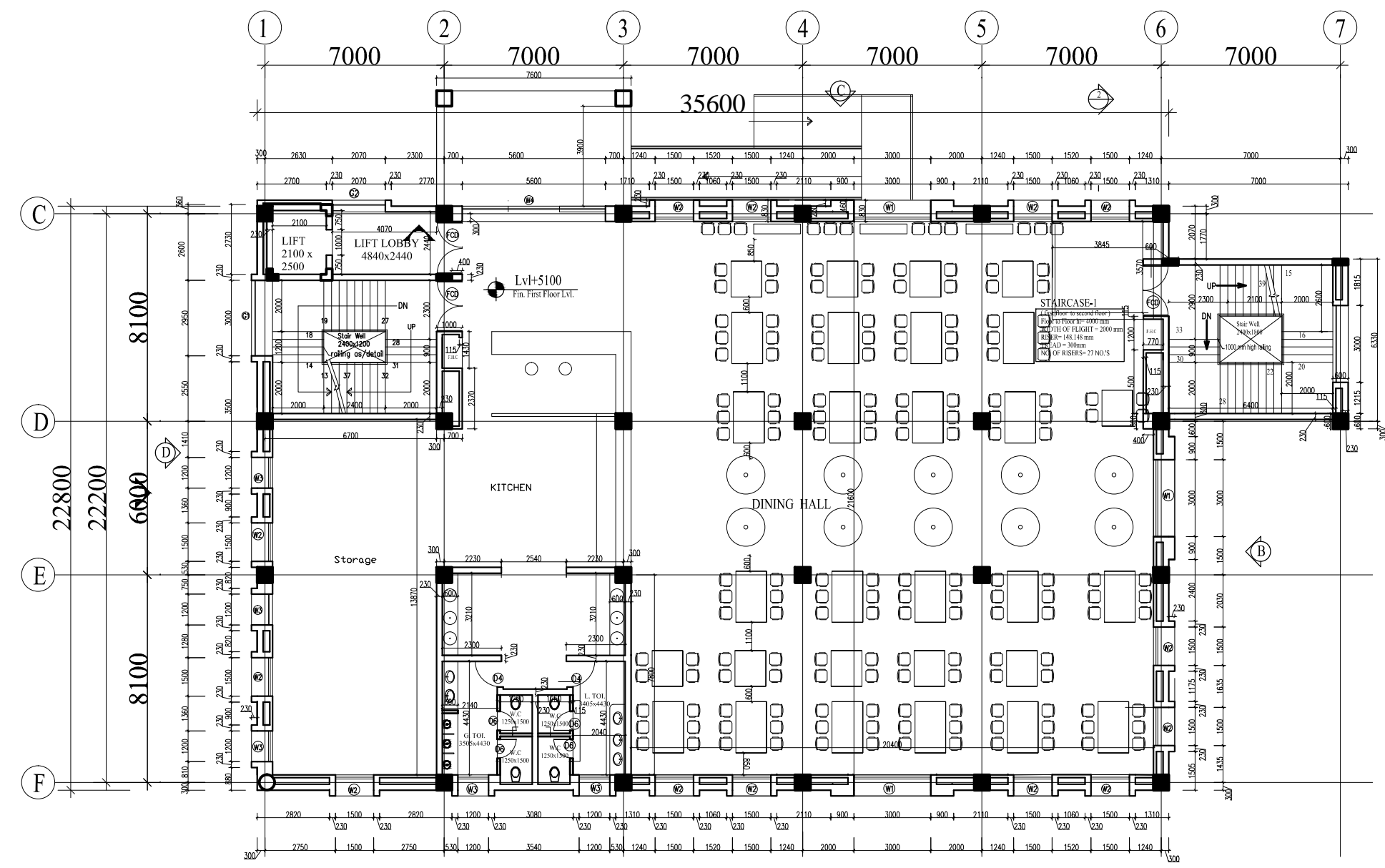

# FIRST FLOOR PLAN

## DOOR / WINDOW SCHEDULE

SND.	TYPE	WIDTH	CILL	LINTEL	REMARKS
01.	FCD	2000	00	2400	
02.	D1	2000	00	2400	
03.	D2	1500	00	2200	
04.	D3	1200	00	2200	
05.	D4	1000	00	2200	
06.	D5	900	00	2200	
07.	D6	750	00	2200	
08.	D7	1000	00	2200	
09.	FDE	1500	00	2200	
10.	S01	1200	00	2200	
11.	W1	3000	300	3300	
12.	W2	1500	300	2400	
13.	W3	1200	1000	2200	
14.	W4	6400	300	3300	
15.	W5	3000	600	2200	
16.	DW1	6400	300	3300	
17.	E1	450	2750	3200	
18.	G1	3000	300	14850	
19.	G2	2070	300	16050	

## PROJECT

**Proposed Master Plan  
Redevelopment For  
Masjid Mod  
All India Institute of  
Medical Science  
New- Delhi**

## TITLE

**WORKING DRAWING**  
BLOCK P-16  
(DINING&PARKING BLOCK)

## FIRST FLOOR PLAN

HSCC/ /002/WD/DB/004/R  
Drawing No.

HSCC/ Job No.	1:100 Scale	JUN 2012 Date
App by	Rev. by	Prep. by

HSCC (INDIA) LIMITED  
(A GOVERNMENT OF INDIA ENTERPRISES)  
**HSCC**  
NEW DELHI INDIA