

This drawing with all its contents is the sole intellectual property of the Hospital Services Consultancy Corporation (India) Ltd. Copying of this drawing or part thereof for its use in any form whatsoever without the written permission

NOTES

NO.	DATE	ISSUED
PRINTS ISSUED		

REV	DATE	DESCRIPTION
REVISION-(R-1)		

PROJECT

Development of 2nd Campus of CNCI at Premises no.02-0321 Plot no.DJ-1/1&DJ 1/2 Action Area -I-D New Town Rajarhat KOLKATA-700156

TITLE

LINEAR ACCELERATOR ROOM-II SECTION Y2-Y2
GROUND FLOOR

SUBMISSION DRAWING

OWNER'S SIGN.

ARCHITECT'S SIGN.

HSCC/CNCI/AERB/RDS/AR-20/11c

DRAWING NO.

HSCC / JOB NO.	1:50 SCALE	JUNE' 2015 DATE
RK App by	JC Chkd. by	SK Prep. by

HOSPITAL SERVICES CONSULTANCY CORPORATION (INDIA) LIMITED (A GOVERNMENT OF INDIA ENTERPRISES)

HSCC
NEW DELHI INDIA

TERRACE

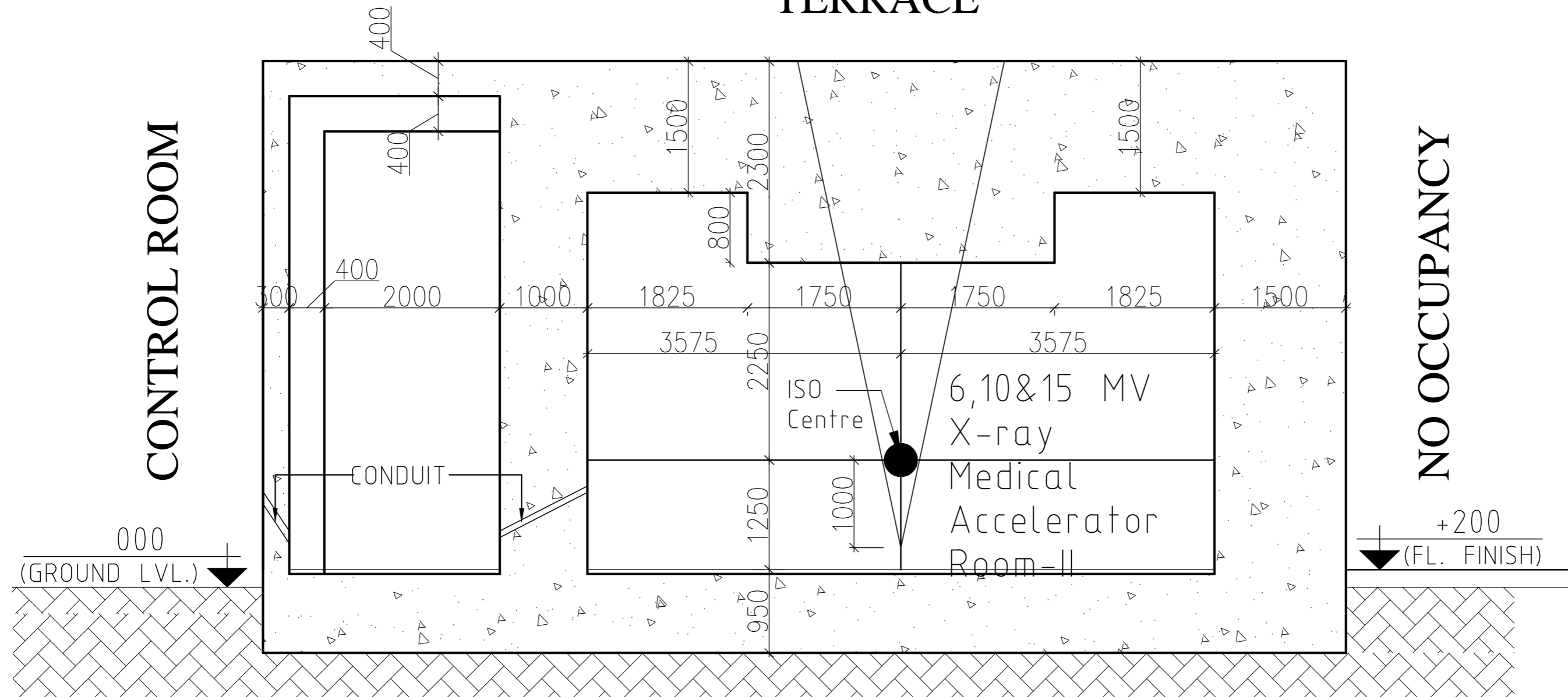

SECTION Y2-Y2

Structure:- Concrete density 2.35 gm/cc.

-  = BRICK WALL
-  = CONCRETE WALL (density 2.35gm/cc.)

This drawing with all its contents is the sole intellectual property of the Hospital Services Consultancy Corporation (India) Ltd. Copying or the drawing or part thereof for its use in any form whatsoever without the written permission

NOTES

NO.	DATE	ISSUED
PRINTS ISSUED		

REV	DATE	DESCRIPTION
REVISION-(R-1)		

PROJECT

Development of 2nd Campus of CNCI at Premises no.02-0321 Plot no.DJ-1/1&DJ 1/2 Action Area -I-D New Town Rajarhat KOLKATA-700156

TITLE

LINEAR ACCELERATOR ROOM-II SECTION Z2-Z2

GROUND FLOOR

SUBMISSION DRAWING

OWNER'S SIGN.

ARCHITECT'S SIGN.

HSCC/CNCI/AERB/RDS/AR-20/11d

DRAWING NO.

HSCC / JOB NO.	1:50 SCALE	JUNE' 2015 DATE
----------------	------------	-----------------

RK App by	JC Chkd. by	SK Prep. by
-----------	-------------	-------------

HOSPITAL SERVICES CONSULTANCY CORPORATION (INDIA) LIMITED (A GOVERNMENT OF INDIA ENTERPRISES)

HSCC
NEW DELHI INDIA

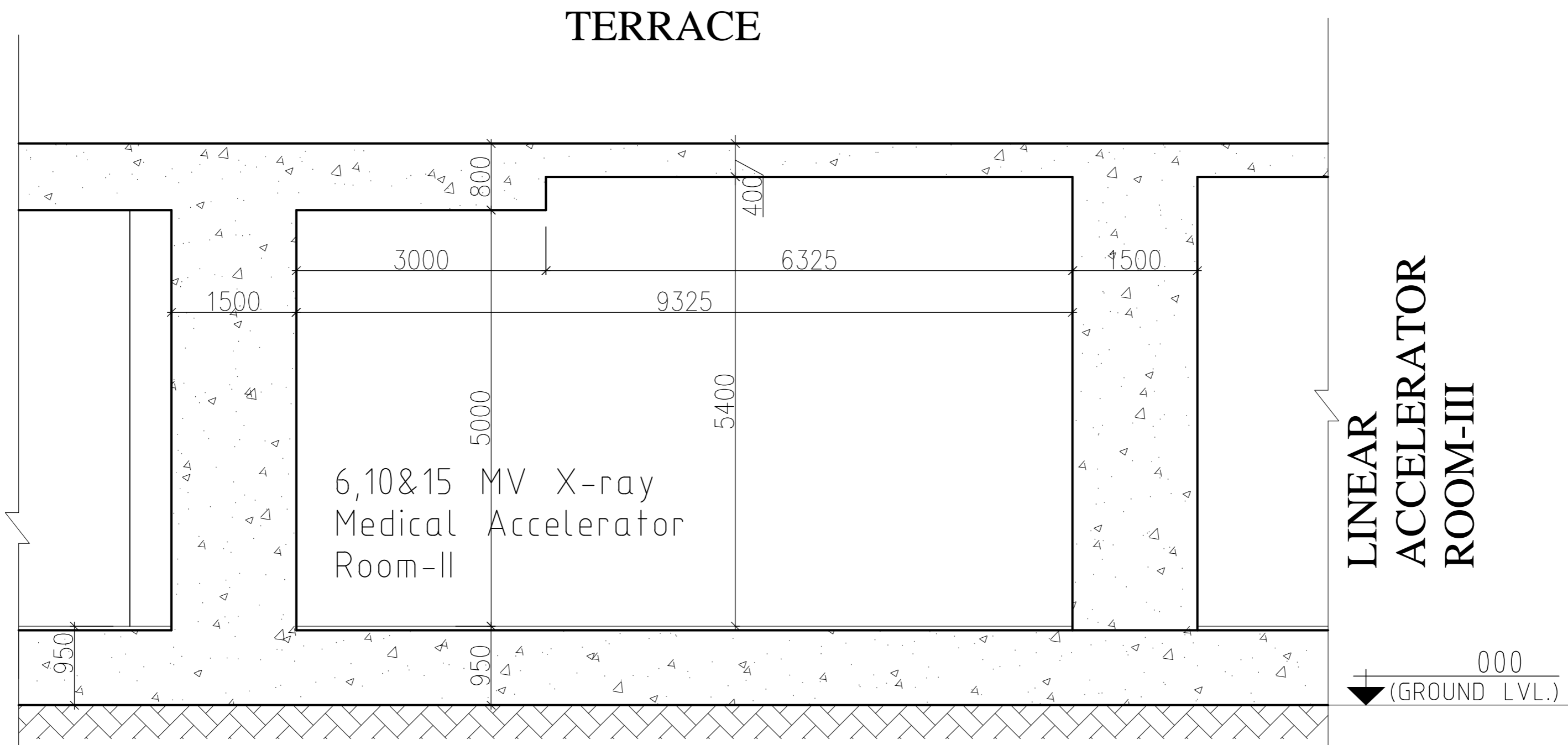

SECTION Z2-Z2

Structure:- Concrete density 2.35 gm/cc.

-  = BRICK WALL
-  = CONCRETE WALL (density 2.35gm/cc.)

This drawing with all its contents is the sole intellectual property of the Hospital Services Consultancy Corporation (India) Ltd. Copying or the drawing or part thereof or its use in any form whatsoever without the written permission

NOTES

NO.	DATE	ISSUED
PRINTS ISSUED		
REV	DATE	DESCRIPTION
REVISION-(R-1)		

PROJECT

Development of 2nd Campus of CNCI at Premises no.02-0321 Plot no.DJ-1/1&DJ 1/2 Action Area -I-D New Town Rajarhat KOLKATA-700156

TITLE

LINEAR ACCELERATOR ROOM-III
GROUND FLOOR

SUBMISSION DRAWING

OWNER'S SIGN.

ARCHITECT'S SIGN.

HSCC/CNCI/AERB/RDS/AR-20/IIIa

DRAWING NO.	HSCC / JOB NO.	1:50 SCALE	JUNE' 2015 DATE
-------------	----------------	------------	-----------------

RK App by	JC Chkd. by	SK Prep. by
-----------	-------------	-------------

HOSPITAL SERVICES CONSULTANCY CORPORATION (INDIA) LIMITED
(A GOVERNMENT OF INDIA ENTERPRISES)

HSCC
NEW DELHI INDIA

NO OCCUPANCY

NO OCCUPANCY

WAITING AREA

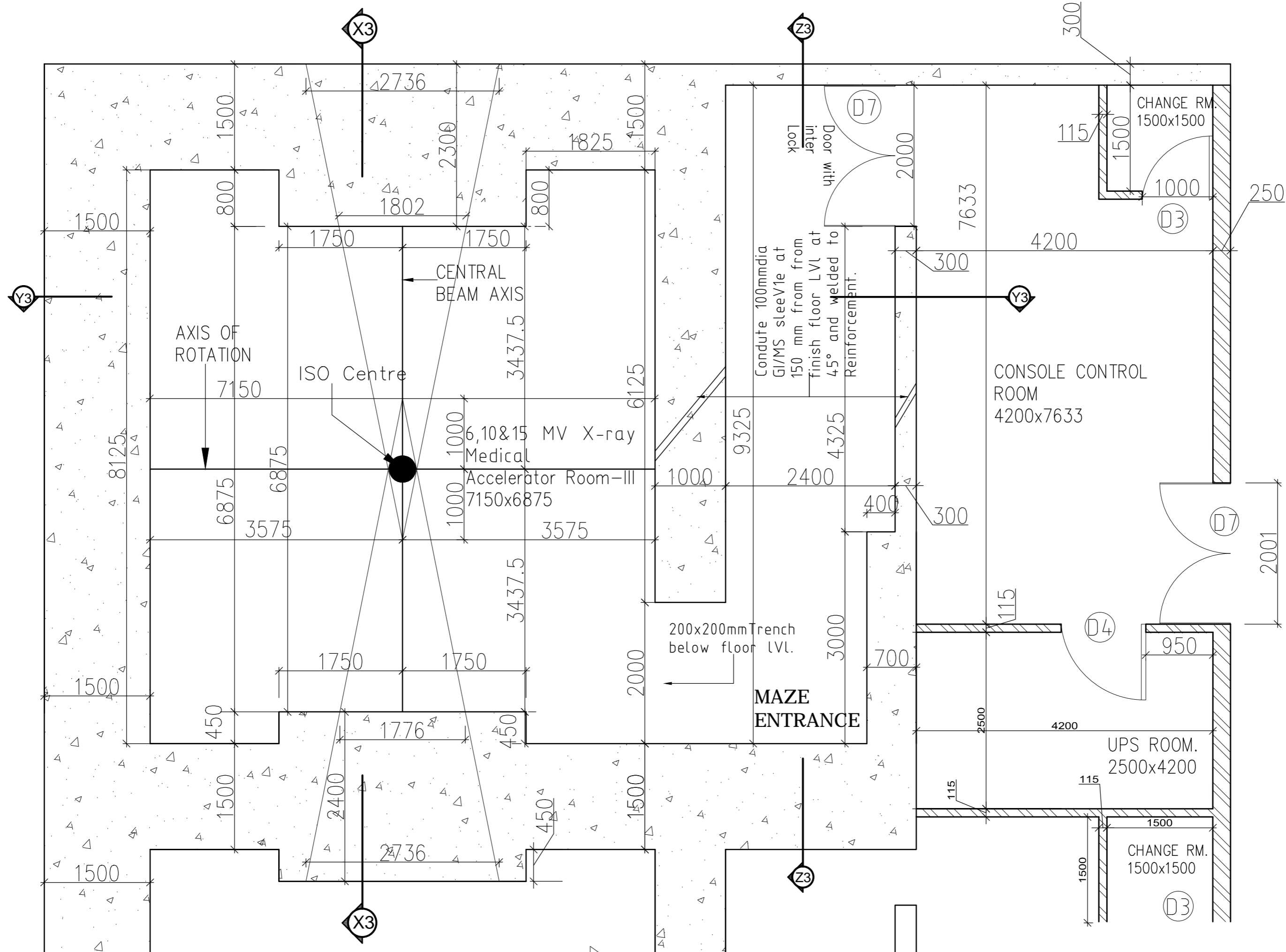

LINEAR ACCELERATOR ROOM-III

LINEAR ACCELERATOR ROOM -II

- = BRICK WALL
- = CONCRETE WALL (density 2.35gm/cc.)

Structure:- Concrete density 2.35 gm/cc.

ALL Dimension are in mm.

This drawing with all its contents is the sole intellectual property of the Hospital Services Consultancy Corporation (India) Ltd. Copying of this drawing or part thereof for its use in any form whatsoever without the written permission

NOTES

NO.	DATE	ISSUED

REV	DATE	DESCRIPTION

PROJECT

Development of 2nd Campus of CNCI at Premises no.02-0321 Plot no.DJ-1/1&DJ 1/2 Action Area -I-D New Town Rajarhat KOLKATA-700156

TITLE

LINEAR ACCELERATOR ROOM-III SECTION -X3-X3
GROUND FLOOR

SUBMISSION DRAWING

OWNER'S SIGN.

ARCHITECT'S SIGN.

HSCC/CNCI/AERB/RDS/AR-20/IIIb

DRAWING NO.

HSCC / JOB NO.	1:50 SCALE	JUNE' 2015 DATE
----------------	------------	-----------------

RK App by	JC Chkd. by	SK Prep. by
-----------	-------------	-------------

HOSPITAL SERVICES CONSULTANCY CORPORATION (INDIA) LIMITED
(A GOVERNMENT OF INDIA ENTERPRISES)

HSCC
NEW DELHI INDIA

TERRACE

LINEAR ACCELERATOR ROOM-II

NO OCCUPANCY

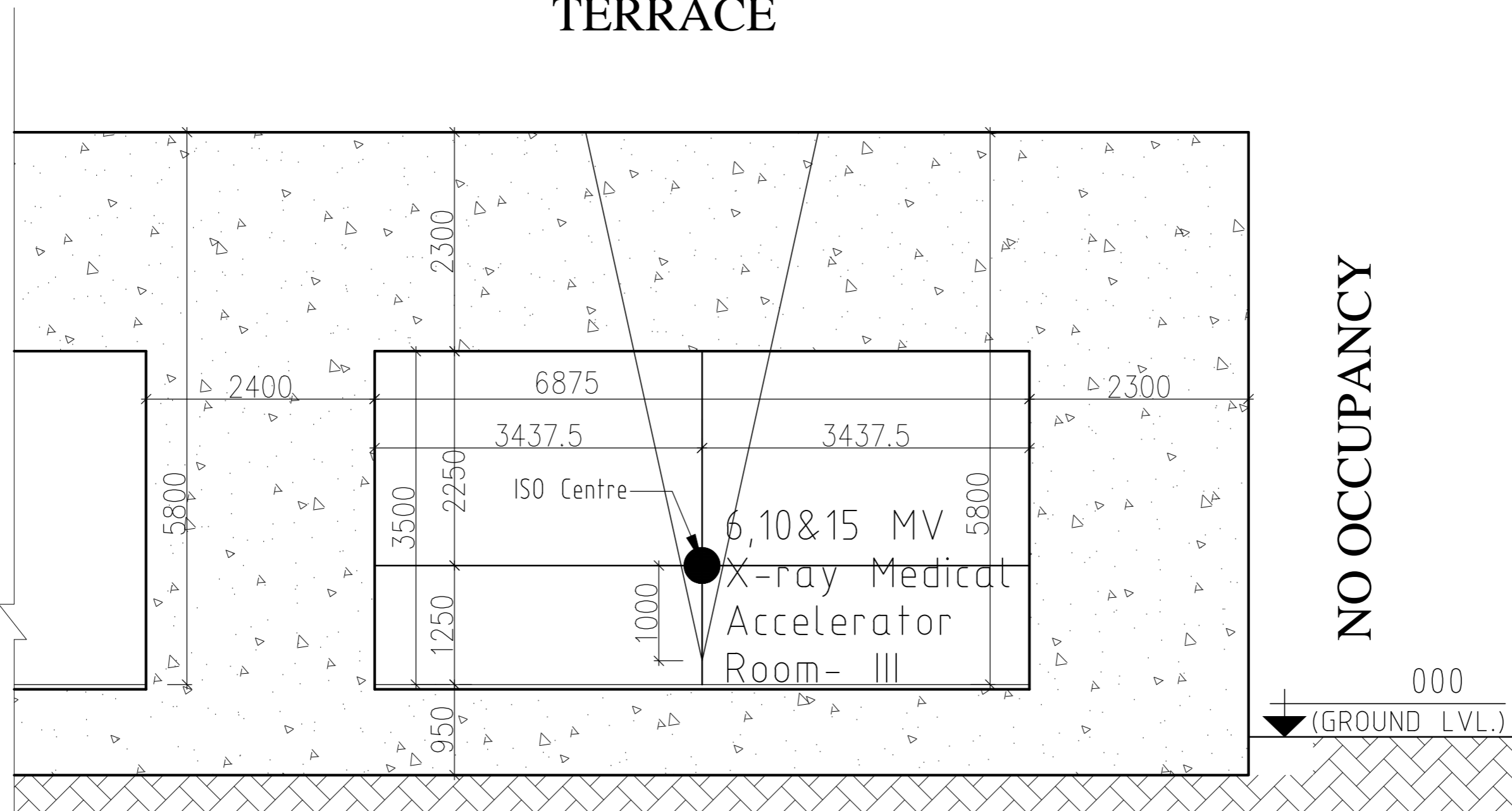

SECTION X3-X3

Structure:- Concrete density 2.35 gm/cc.



= BRICK WALL



= CONCRETE WALL (density 2.35gm/cc.)

This drawing with all its contents is the sole intellectual property of the Hospital Services Consultancy Corporation (India) Ltd. Copying of this drawing or part thereof for its use in any form whatsoever without the written permission

NOTES

NO.	DATE	ISSUED
PRINTS ISSUED		

REV	DATE	DESCRIPTION
REVISION-(R-1)		

PROJECT

Development of 2nd Campus of CNCI at Premises no.02-0321 Plot no.DJ-1/1&DJ 1/2 Action Area -I-D New Town Rajarhat KOLKATA-700156

TITLE

LINEAR ACCELERATOR ROOM-III SECTION -Y3-Y3

GROUND FLOOR

SUBMISSION DRAWING

OWNER'S SIGN.

ARCHITECT'S SIGN.

HSCC/CNCI/AERB/RDS/AR-20/IIIc

DRAWING NO.

HSCC / JOB NO.	1:50 SCALE	JUNE' 2015 DATE
----------------	------------	-----------------

RK App by	JC Chkd. by	SK Prep. by
-----------	-------------	-------------

HOSPITAL SERVICES CONSULTANCY CORPORATION (INDIA) LIMITED (A GOVERNMENT OF INDIA ENTERPRISES)

HSCC
NEW DELHI INDIA

TERRACE

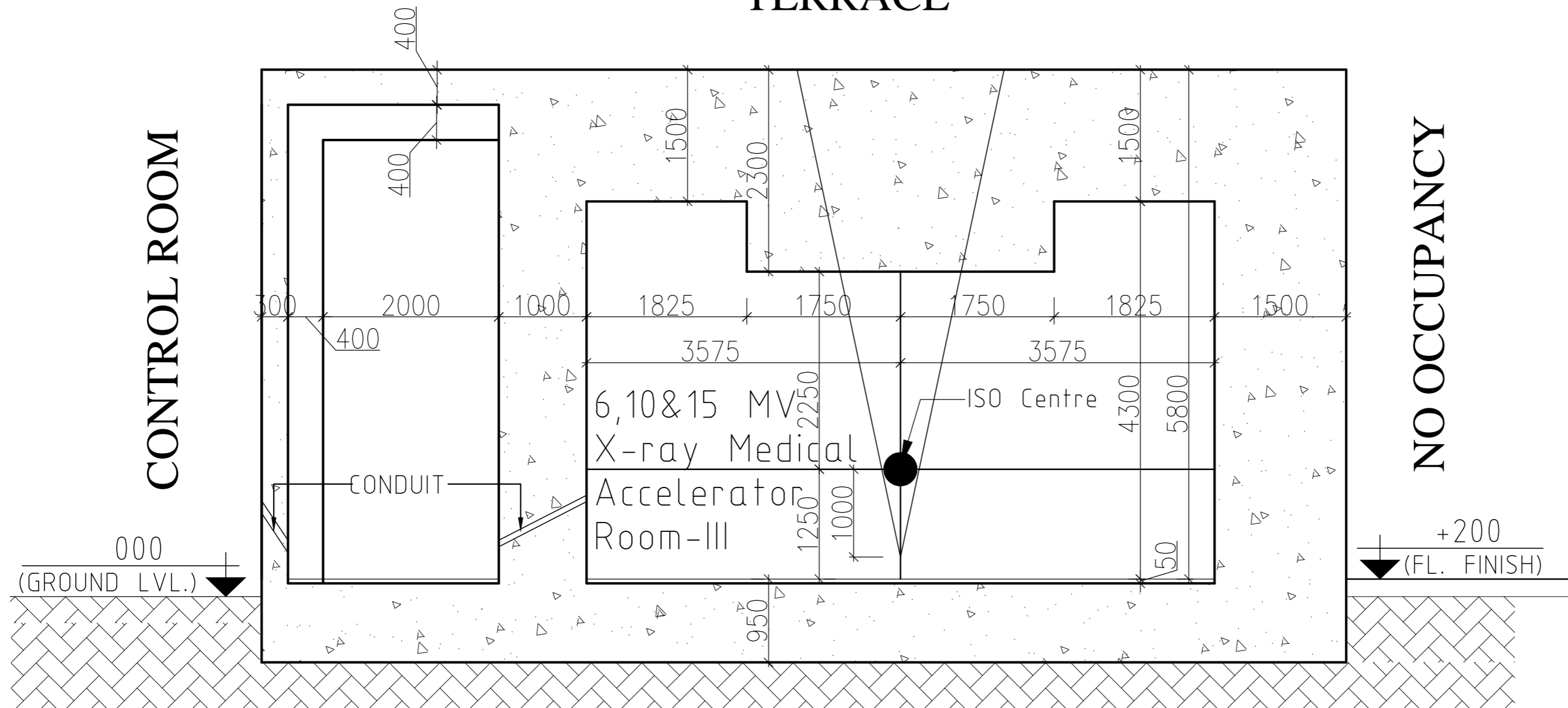

SECTION Y3-Y3

Structure:- Concrete density 2.35 gm/cc.

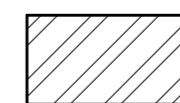

= BRICK WALL

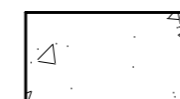

= CONCRETE WALL (density 2.35gm/cc.)

This drawing with all its contents is the sole intellectual property of the Hospital Services Consultancy Corporation (India) Ltd. Copying of this drawing or part thereof for its use in any form whatsoever without the written permission

NOTES

LINEAR ACCELERATOR ROOM - II

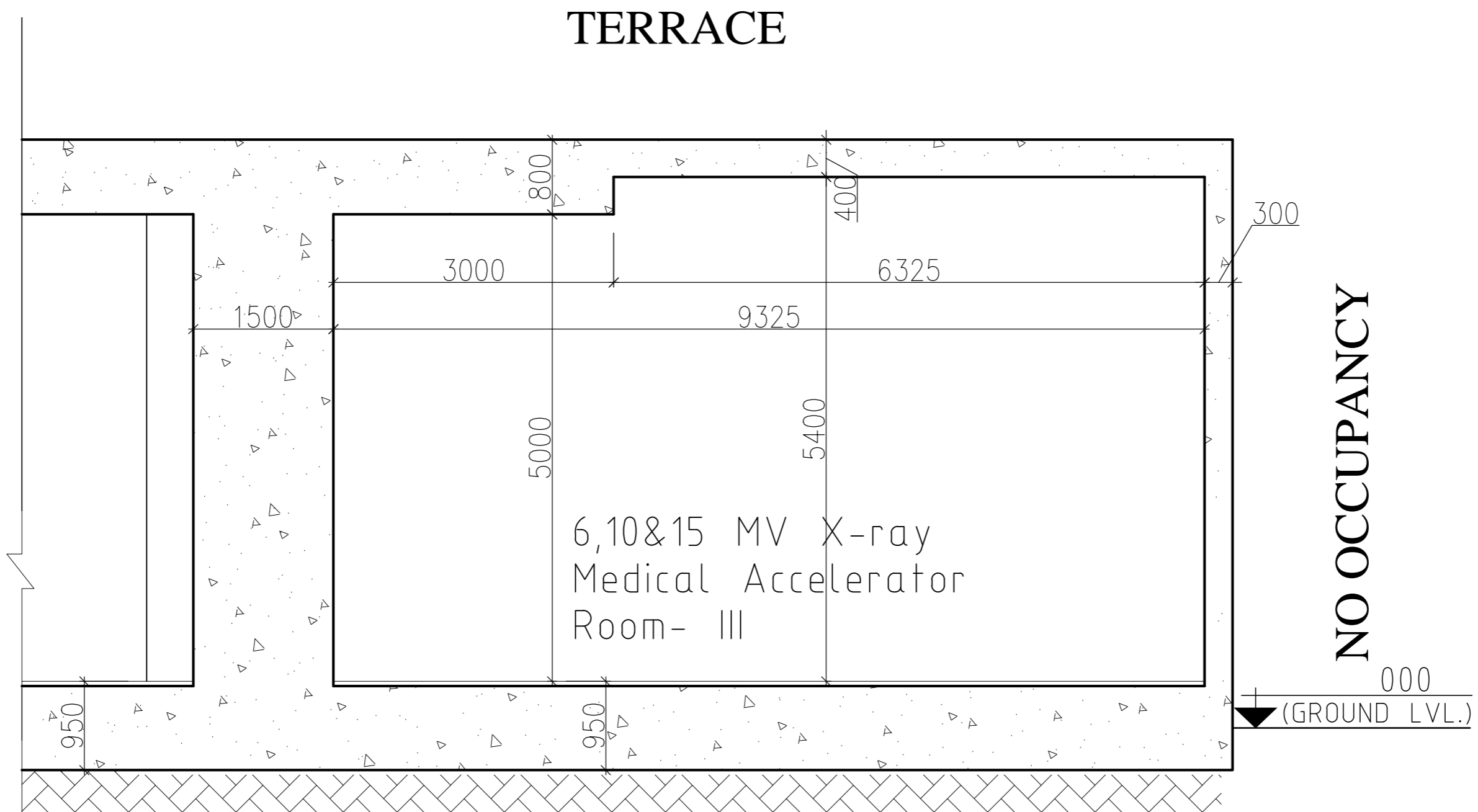

SECTION Z3-Z3

Structure:- Concrete density 2.35 gm/cc.

 = BRICK WALL

 = CONCRETE WALL (density 2.35gm/cc.)

NO.	DATE	ISSUED
PRINTS ISSUED		
REV	DATE	DESCRIPTION
REVISION-(R-1)		

PROJECT
 Development of 2nd Campus of CNCI at Premises no.02-0321 Plot no.DJ-1/1&DJ 1/2 Action Area -I-D New Town Rajarhat KOLKATA-700156

TITLE
 LINEAR ACCELERATOR ROOM-III SECTION Z3-Z3
 GROUND FLOOR

SUBMISSION DRAWING

OWNER'S SIGN.

ARCHITECT'S SIGN.

HSCC/CNCI/AERB/RDS/AR-20/IIIId

DRAWING NO.

HSCC / JOB NO.	1:50 SCALE	JUNE' 2015 DATE
----------------	------------	-----------------

RK App by	JC Chkd. by	SK Prep. by
-----------	-------------	-------------

HOSPITAL SERVICES CONSULTANCY CORPORATION (INDIA) LIMITED
 (A GOVERNMENT OF INDIA ENTERPRISES)
HSCC
 NEW DELHI INDIA

NOTES

NO.	DATE	ISSUED
PRINTS ISSUED		

REV	DATE	DESCRIPTION
REVISION R-1		

PROJECT

Development of 2nd Campus of CNCI at Premises no.02-0321 Plot no.DJ-1/1&DJ 1/2 Action Area -I-D New Town Rajarhat KOLKATA-700156

TITLE

CT-Simulator room Layout Drawing

SUBMISSION DRAWING

OWNER'S SIGN.

ARCHITECT'S SIGN.

HSCC/CNCI/006/AERB/AR-23/a

DRAWING NO.	HSCC / JOB NO.	1:50 SCALE	June' 2015 DATE
-------------	----------------	------------	-----------------

RK App by	JC Chkd. by	SK Prep. by
-----------	-------------	-------------

HOSPITAL SERVICES CONSULTANCY CORPORATION (INDIA) LIMITED (A GOVERNMENT OF INDIA ENTERPRISES)

HSCC
NEW DELHI INDIA

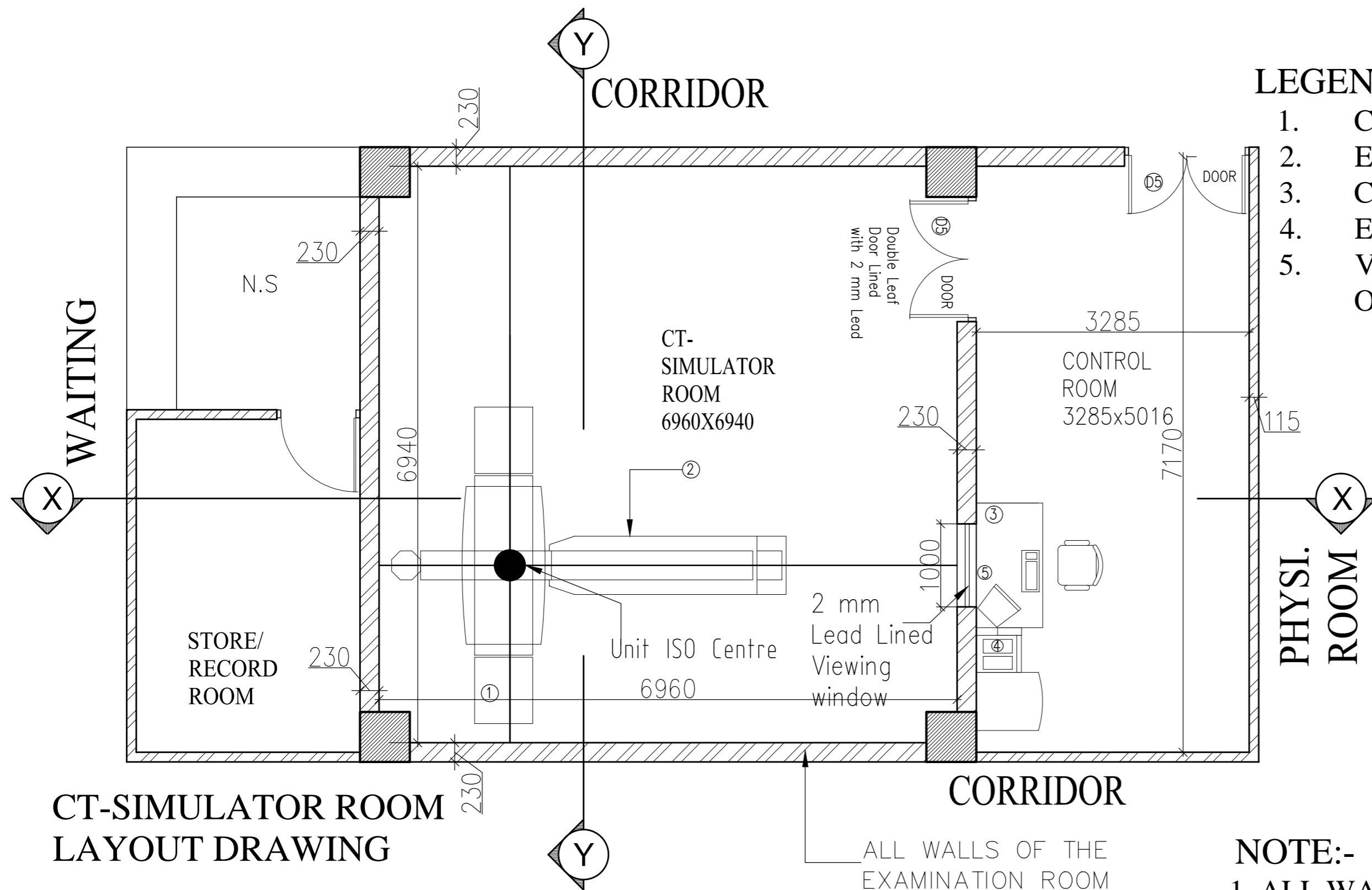

LEGEND:-

1. C.T.GANTRY
2. EXAMINATION TABLE
3. CONTROL UNIT
4. ELECTRONICS
5. VIEWING GLASS 1000x800mm OF 2mm LEAD EQUIVALENCE

CT-SIMULATOR ROOM LAYOUT DRAWING

= BRICK WALL

= CONCRETE WALL (density 2.35gm/cc.)

Structure:- Concrete density 2.35 gm/cc.

ALL WALLS OF THE EXAMINATION ROOM ARE 230mm(9") Thick. MADE OF BRICKS.

NOTE:-

1. ALL WALLS OF THE EXAMINATION ROOM ARE 230mm Thick. MADE OF BRICKS.
2. CEILING OF C.T.SIMULATOR ROOM IS 230 MM THICK MADE OF CONCRETE (RCC) OF DENSITY 2.35gm/CC.

The drawing with all its contents is the sole intellectual property of the Hospital Services Consultancy Corporation (India) Ltd. Copying or reuse of any part hereof without the written permission is prohibited.

NOTES

NO.	DATE	ISSUED
PRINTS ISSUED		

REV.	DATE	DESCRIPTION
REVISION-(R-1)		

PROJECT
 Development of 2nd Campus of Chittaranjan National Cancer Institute at Premises no.02-0321 Plot no.DJ-1/1&DJ 1/2 Action Area -I-D New Town Rajarhat KOLKATA-700156

TITLE
 PET-CT & SPECT-CT ROOM LAYOUT
 AT FIRST FLOOR

SUBMISSION DRAWING

OWNER'S SIGN.

ARCHITECT'S SIGN.

HSCC/CNCI/AERB/RDS/AR-03		
DRAWING NO.	1:100	26.03.2018
HSCC/ JOB NO.	SCALE	DATE
RK App by	JC Chkd. by	SK Prep. by

HOSPITAL SERVICES CONSULTANCY CORPORATION (INDIA) LIMITED
 (A GOVERNMENT OF INDIA ENTERPRISE)
HSCC
 NEW DELHI INDIA

Legend
 Wall panel with 1mm thick lead lining

= BRICK WALL
 = CONCRETE WALL (DENSITY 2.35gm/cc.)

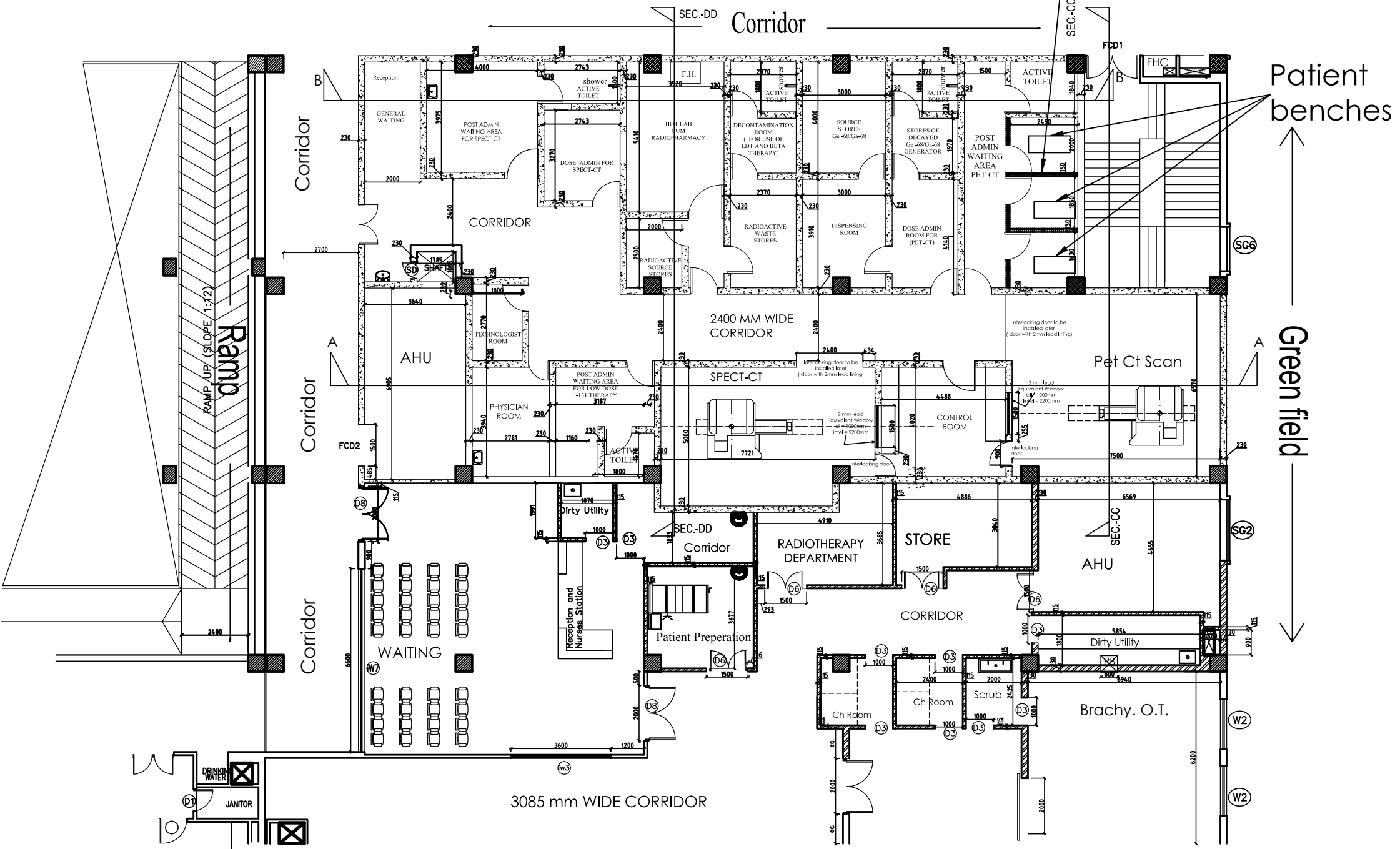

FIRST FLOOR