

HSCC (India) Limited
for and on behalf of
SHYAM SHAH MEDICAL COLLEGE, REWA

TENDER

FOR

Redevelopment works including extension of Maternity Wing, Pediatric Department, Toilet Block, etc., landscaping, external development and other Renovation works at Shyam Shah Medical College, Rewa and associated Gandhi Memorial and Sanjay Gandhi Memorial Hospitals, Rewa (M.P.) including Civil, Plumbing, HVAC, Lift, internal electrification & OT Works

VOLUME – VI

Tender Drawing

June 2018

Consultant



HSCC (INDIA) LTD.

E-6(A), Sector-1, NOIDA(U.P) 201301 (India)

Phone : 0120-2542436-40

Fax : 0120-2542447

Tender No. HSCC/Rewa/SSMC/2018/10498

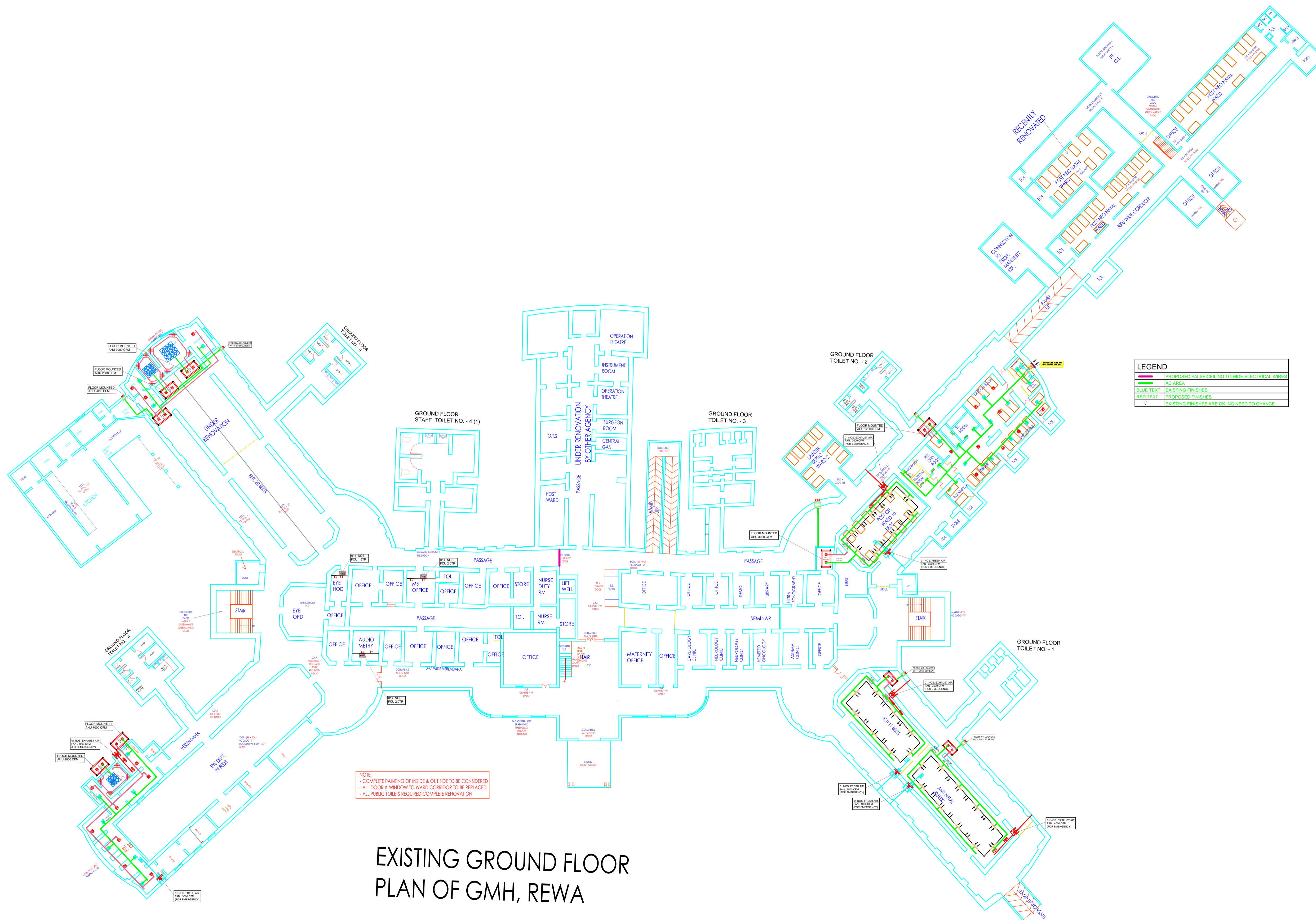

EXISTING GROUND FLOOR
PLAN OF GMH, REWA

REV	DATE	DESCRIPTION

GMH PROJECT

GANDHI MEMORIAL
HOSPITAL AT REWA

TITLE

TENDER DRAWING
(SCHEME PURPOSE ONLY)

HVAC LAYOUT
GROUND FLOOR PLAN

HSCC/D&E/HVAC/GMH-REWA /AC-01
Drawing No.

Job No.	Scale	Date
App by	Chkd. by	Prep. by

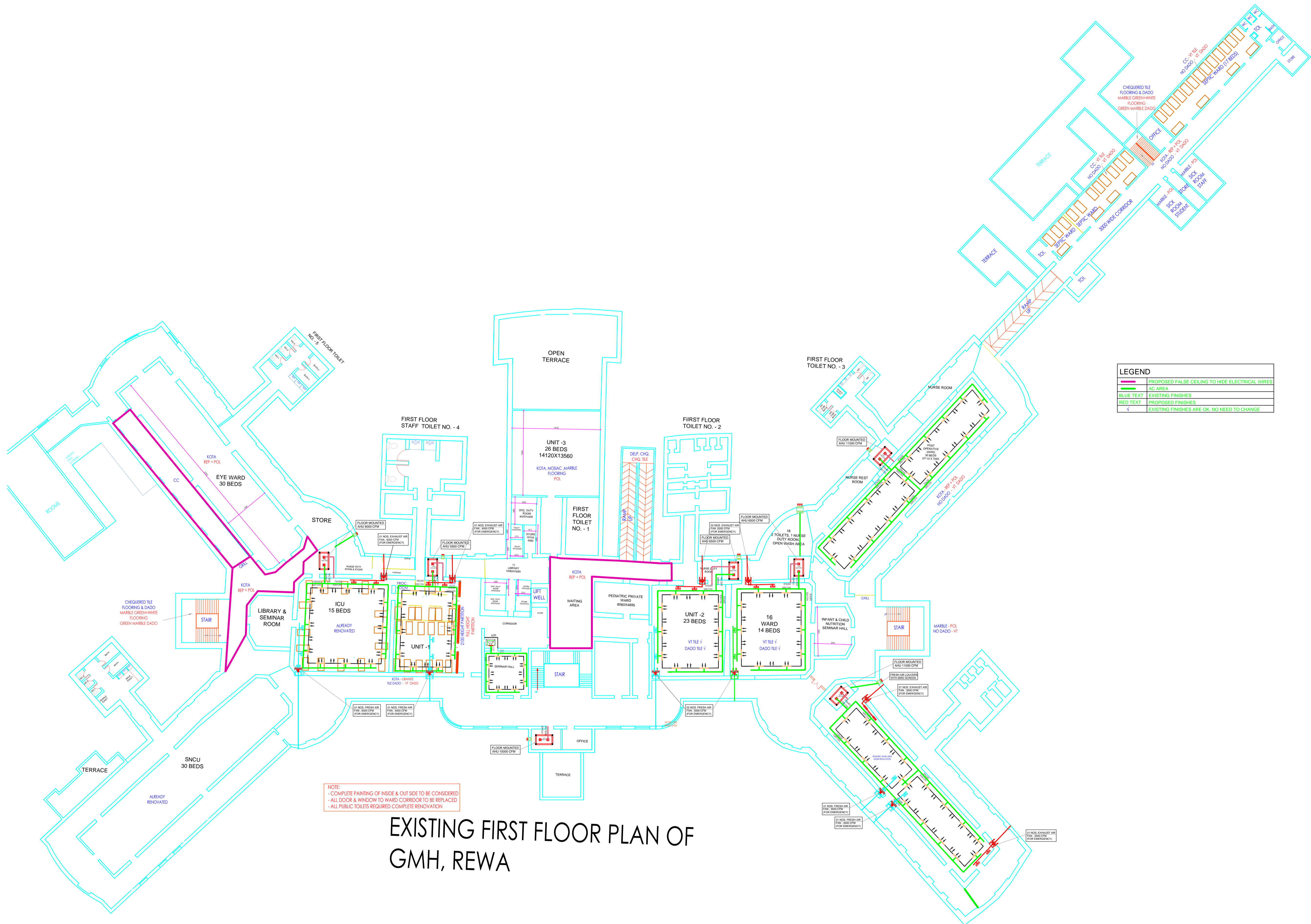

EXISTING FIRST FLOOR PLAN OF GMH, REWA

NOTE:
 - COMPLETE PAINTING OF INSIDE & OUT SIDE TO BE CONSIDERED
 - ALL DOOR & WINDOW TO WARD CORRIDOR TO BE REPLACED
 - ALL PUBLIC TOILETS REQUIRED COMPLETE RENOVATION

LEGEND	
—	PROPOSED FALSE CEILING TO HIDE ELECTRICAL WIRES
—	AC AREA
—	EXISTING FINISHES
—	PROPOSED FINISHES
v	EXISTING FINISHES ARE OK, NO NEED TO CHANGE

REV	DATE	DESCRIPTION

GMH PROJECT

GANDHI MEMORIAL HOSPITAL AT REWA

TENDER DRAWING
 (SCHEME PURPOSE ONLY)

HVAC LAYOUT FIRST FLOOR PLAN

HSCC/D&E/HVAC/GMH-REWA /AC-02
 Drawing No.

Job No.	Scale	Date
App by	Chkd. by	Prep. by

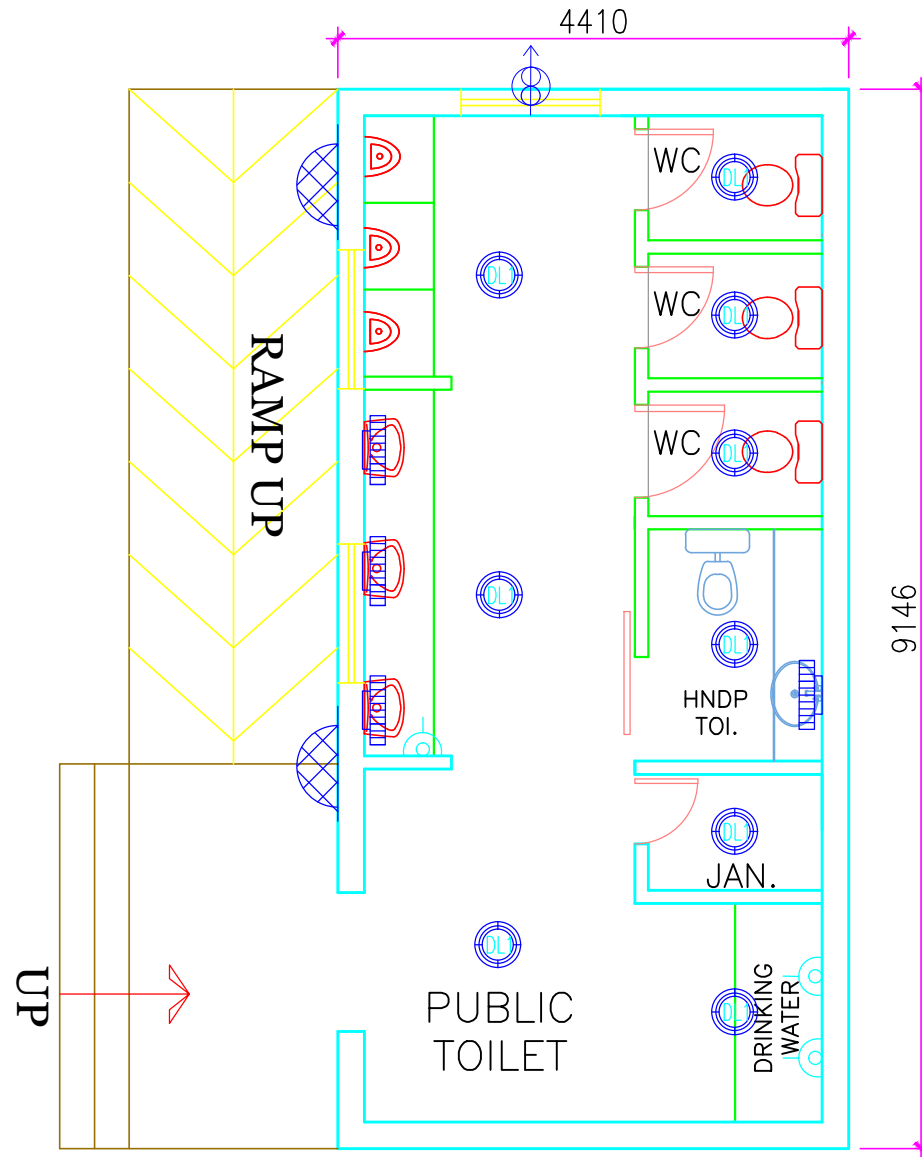

GROUND FLOOR
AREA - 40 SQM

PROJECT:

PROPOSED REDEVELOPMENT OF GMH, REWA

BLOCK:

PUBLIC TOILET

FLOOR:

GROUND FLOOR

HSCC

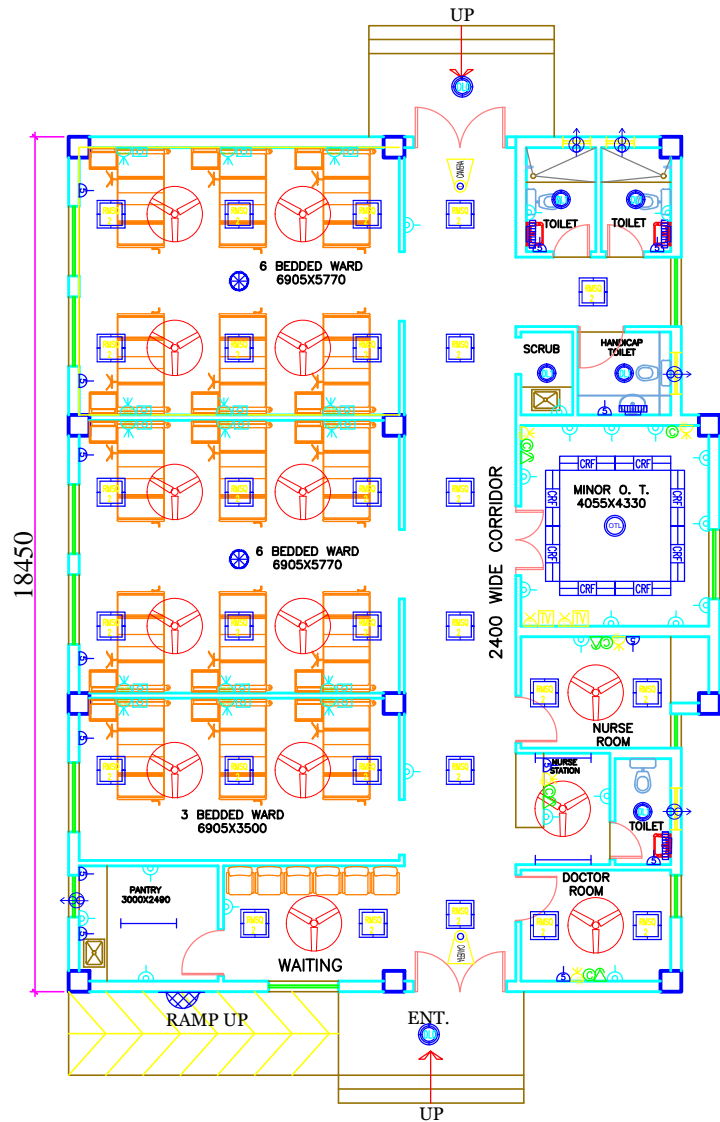

GROUND FLOOR
AREA - 250 SQM

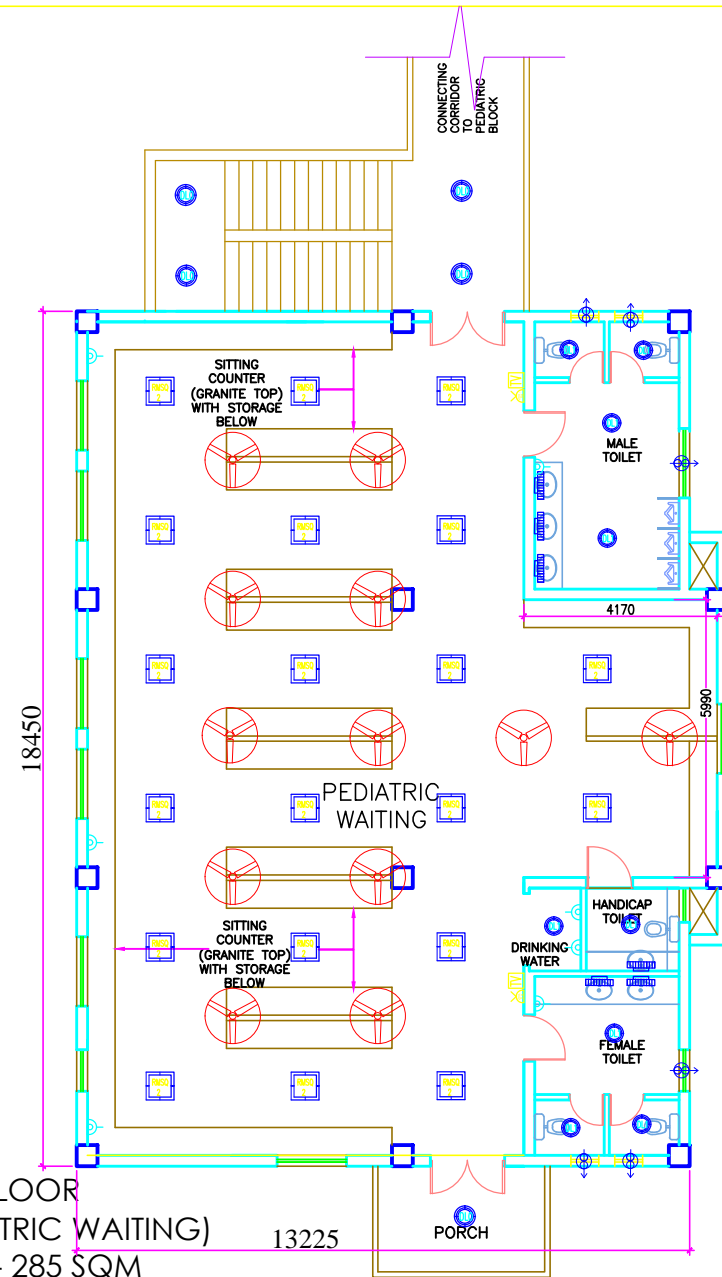

PROJECT:

PROPOSED REDEVELOPMENT OF GMH, REWA

BLOCK:
EYE WARD &
PEDIATRIC WAITING
FLOOR:

GROUND FLOOR

HSCC

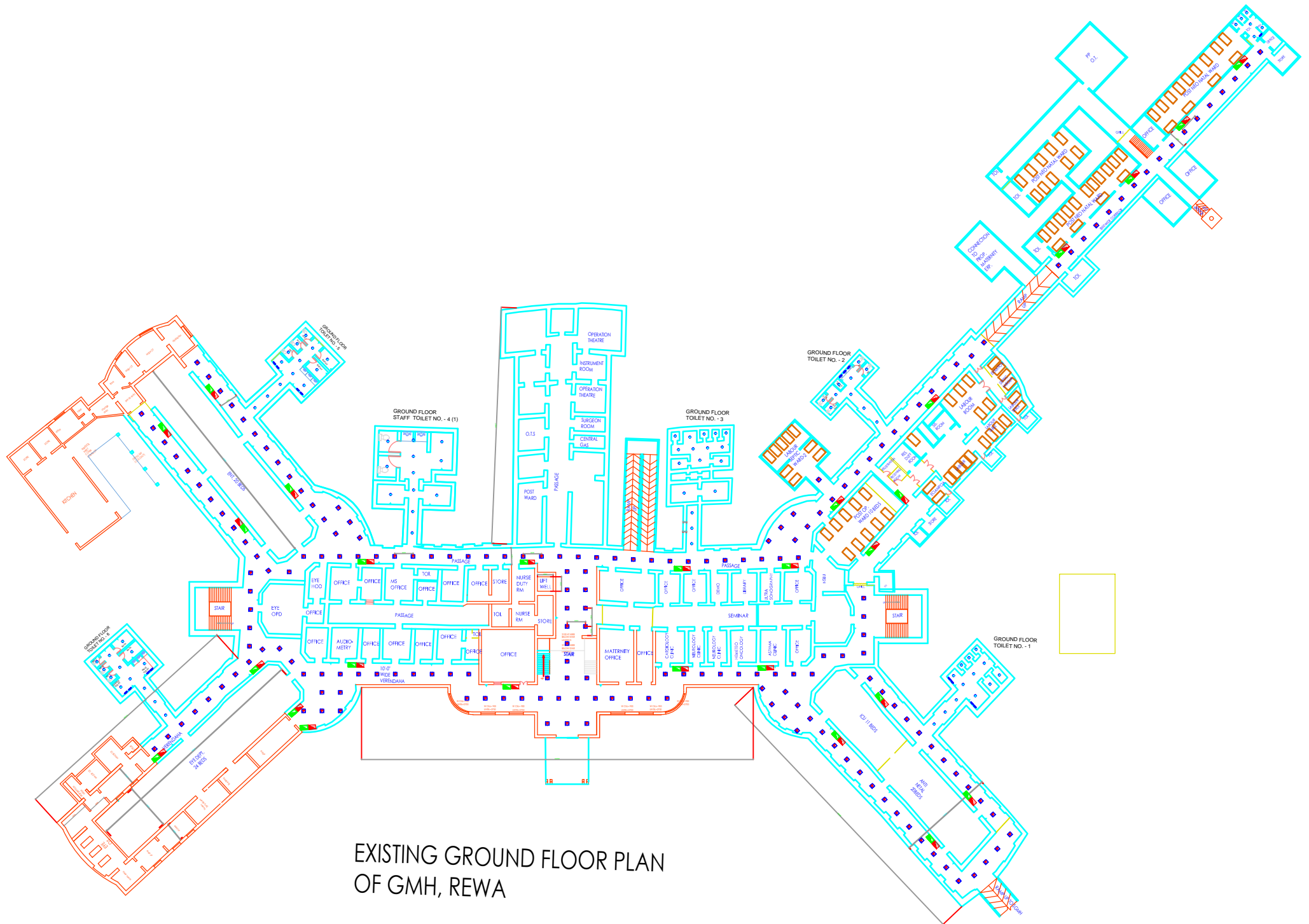

EXISTING GROUND FLOOR PLAN
OF GMH, REWA

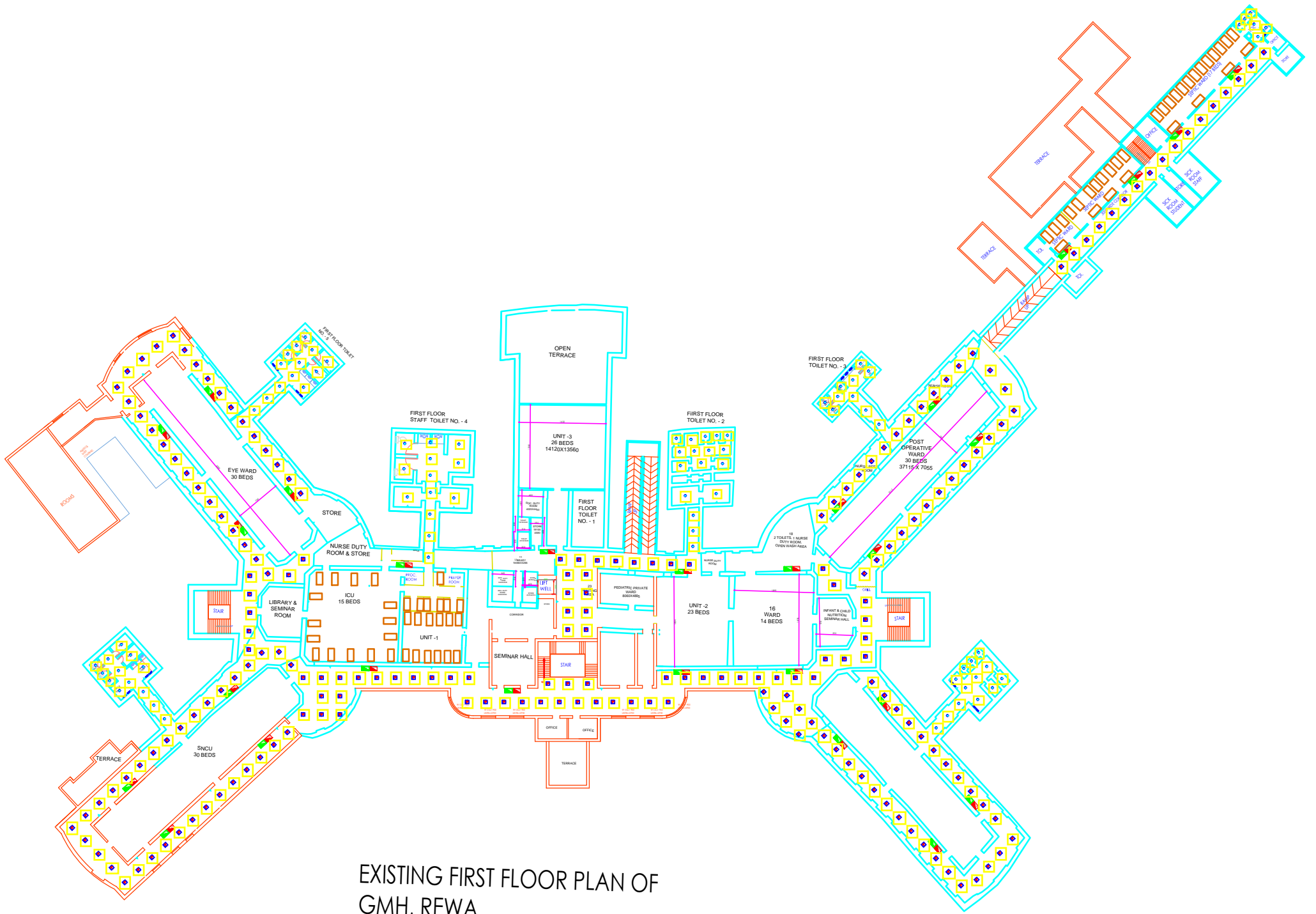

EXISTING FIRST FLOOR PLAN OF
GMH, REWA