

No.: HSCC/Pali- Raj/MC/RFP/2015-2

Date: 18.11.2015

Amendment-2

Pre-Bid Queries & Replies/ Clarifications

Subject: Appointment of Design Consultant for Comprehensive Master Planning & Construction of 100 Student Intake Medical College including up-gradation of Existing Hospital as per MCI Guidelines with other facilities at District Pali, Medical Education Department, Govt. of Rajasthan- Pre Bid meeting dated 17.11.2015.

Tender No.: HSCC/Pali- Raj/MC/RFP/2015 dated 04.11.2015.

As requested by the bidders during the pre-bid meeting held on 17.11.2015, drawing of the proposed land of the Medical College at Pali in pdf format is attached herewith as Annexure-1. This is in line with the details/ drawing already provided in the Tender Documents.

Prospective bidders are advised to regularly scan through HSCC web site as corrigendum/ amendments etc., if any, will be notified on the HSCC web site and no separate advertisement will made for this.

Chief General Manager,
For & on behalf of Medical Education Department, Govt. of Rajasthan.

MEDICAL COLLEGE PROPOSED LAND

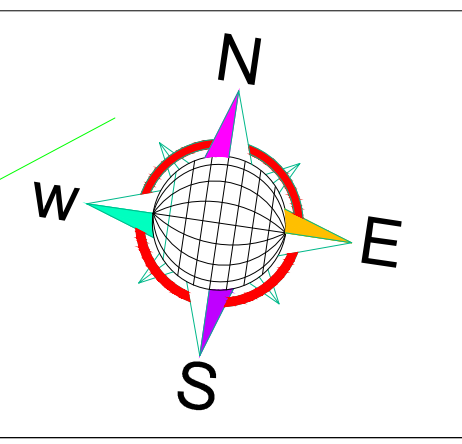
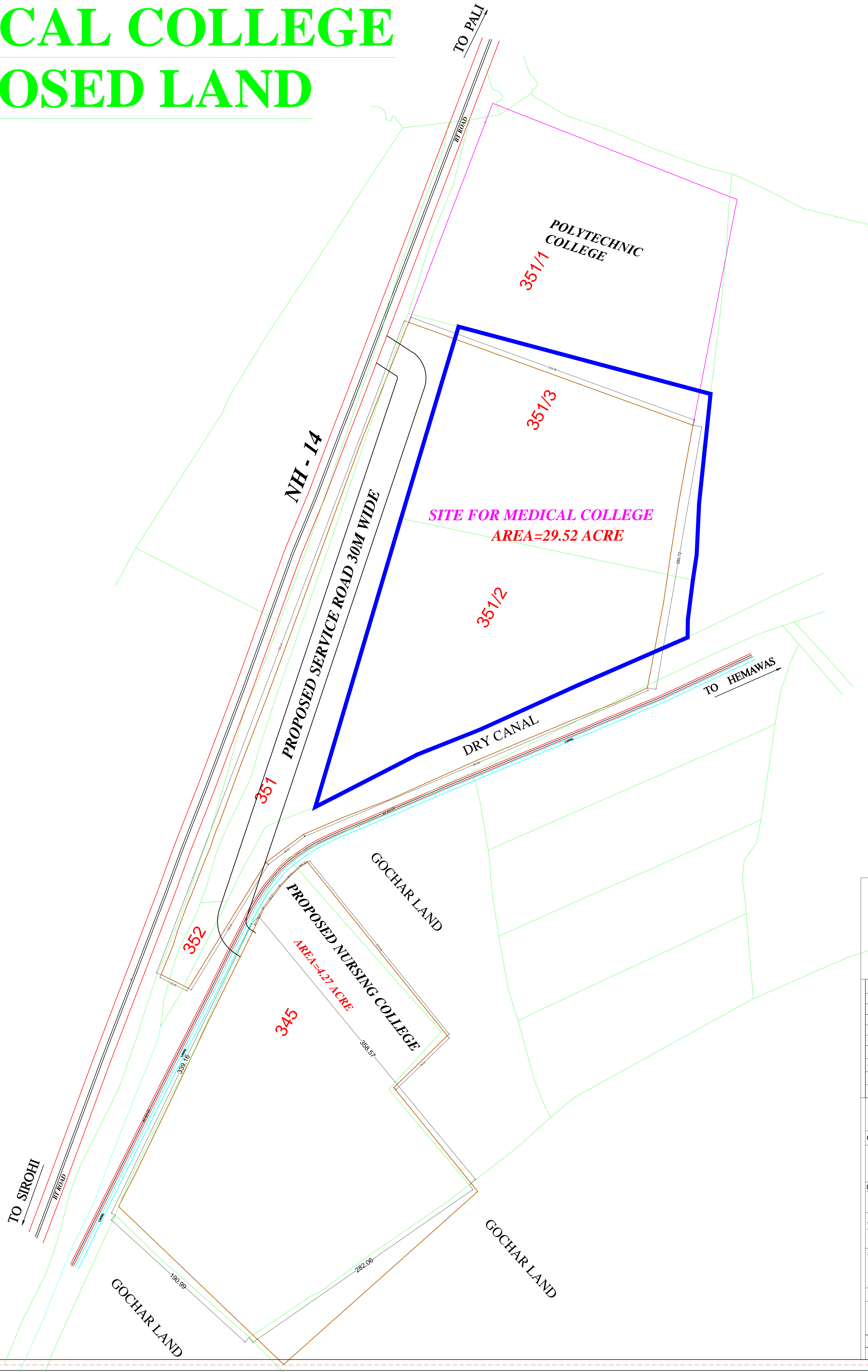

LEGEND

	SURVEY BOUNDARY		TREE
	PROPOSED LAND		L.T. POLE
	KHASRA BOUNDARY		ELECTRIC POLE/E.B.
	BORING		TELEPHONE POLE/T.B.
	WELL & WATER TANK		TRANSFORMER
	HAND PUMP		LAMP POST/ROAD LIGHT
	CENTER LINE		ESR
	DIVIDER		HOSPITAL
	HOUSE/BLDS/STRUCTURE		HT LINE

CLIENT :-

CONTRACTOR :-

PROJECT:-

TITLE:- **SITE FOR MEDICAL COLLEGE (PALI)**

SCALE:- **TOTAL AREA-29.52 ACRE**

DRG No.

DRAWN BY :	RECOM. BY :	CHECKED BY :	APPROVED BY :
------------	-------------	--------------	---------------